

GEOLOGIC RESERVOIR STUDY OF THE SWAN HILLS FORMATION HANLAN BHL 'A' AND 'B' POOLS WEST CENTRAL ALBERTA

This study successfully subdivides the dolomitized reservoir section at the Hanlan BHL 'A' and 'B' pools. Mapping at a number of levels in the Swan Hills platform phase reveals the control of primary depositional facies on subsequent dolomite reservoir quality.

The study provides a fully documented template with which to view exploration opportunities at both the shoal and platform level along the regional Swan Hills edge in West Central Alberta.

Product Includes:

- Fully documented report illustrated with figures, maps and core photos;
- 6 maps @ 1:50,000 scale displaying facies, isopach edges and structure;
- 7 stratigraphic cross sections (5 dip and 2 strike) displaying all study wells;
- Database of 30 wells with 6 internal Swan Hills Fm picks and 4 Beaverhill Lake Grp. marker picks;
- 18 core descriptions (655 metres) with internally consistent correlations.

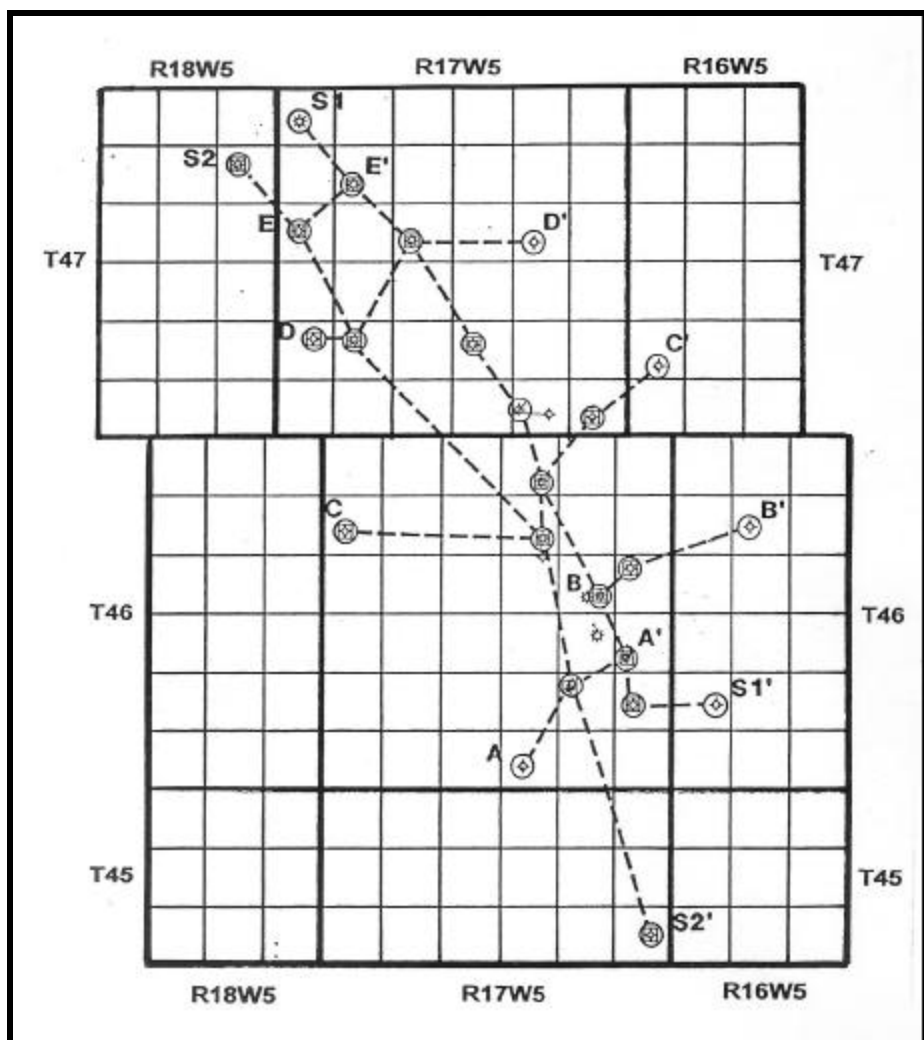

for more information or to arrange a technical presentation,
call (403) 262-6003 or fax (403)265-4662

SCG LTD.
STOAKES CONSULTING GROUP